

MV-PD010003-21IH

Logistic Code Reading Set



Introduction

MV-PD010003-21IH logistic code reading set integrates functions of image acquisition, data processing, and result output. It not only improves the efficiency of image data transmission and processing, but also reduces the performance requirements for supporting devices. It is widely used in code recognition scenarios in the express logistics industry.

Available Model

MV-PD010003-21IH

Applicable Industry

Logistics code reading, warehouse sorting, etc.

Key Feature

- Built-in code reading algorithm to read different types of one-dimensional and two-dimensional codes with good robustness.
- Integrates functions of image acquisition, data processing, and result output.
- Adopts integrated structure design for convenient installation.
- Centralized light with high luminescence efficiency.
- Long lifetime, stable performance, and strong environmental compatibility.

Dimension

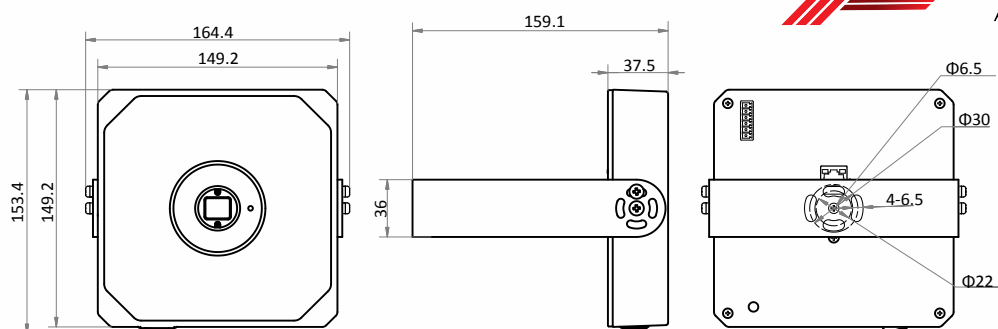

Unit: mm



Presented by: A-TECH AUTOMATION
sales@a-tech.ca www.a-tech.ca
Direct: 416 754 7008
Toll Free: 1 888 754 7008

Specification

Model	MV-PD010003-21IH
Performance	
Symbologies	1-dimensional codes: Code 128, Code 39, Code 93, CodaBar, EAN, ITF25 2-dimensional codes: QR Code, Data Matrix
Max. frame rate	16 fps
Max. reading speed	48 codes/sec
Focal length	12 mm (0.5")
Best working distance	1050 mm (41.3")
Field of view (range)	650 mm × 440 mm @10 mil
Depth of field	600 mm (23.6")
Resolution	3072 × 2048
Exposure time	16 µs to 1 sec
Gain	0 dB to 30 dB
Aperture	F2.8 to F16
Center illuminance	5800 lux @1000 mm
Uniformity	0.53
Luminous flux	2500 lm
Light source wavelength	420 nm to 730 nm
Color temperature	5700 K
Electrical feature	
Data interface	Gigabit Ethernet
Digital I/O	6-pin green terminal provides power and I/O, including opto-isolated input × 1 (LineIn 0), and opto-isolated output × 1 (LineOut 0).
Power supply	24 VDC
Max. power consumption	28 W @24 VDC
Mechanical	
Dimension (without lens)	153.4 mm × 164.4 mm × 159.1 mm (6.0" × 6.5" × 6.3")
Weight (without lens)	Approx. 990 g (2.2 lb.)
Temperature	Working temperature: 0 °C to 50 °C (32 °F to 122 °F) Storage temperature: -30 °C to 70 °C (-22 °F to 158 °F)
Humidity	20% to 80% RH, non-condensing
General	
Client software	IDMVS
Operating system	32/64-bit Windows XP/7/10
Certification	CE, FCC

Note:

- Do not directly touch cooling parts of the device to avoid scald.
- Do not debug the device for a long time in close distance to avoid scald.